

Energizer[®]

**WIRELESS
CHIME**

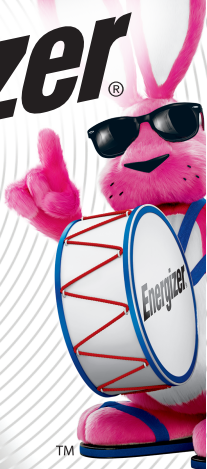

Step 3

Wireless Chime

EOD1-1003-CHM

QUICK START GUIDE

Compatible with Energizer Video Doorbell

EOD1-1001, EOD1-1002, EOD1-1003

v1.3

Use this guide to finalize setup of your Wireless Chime.

Wireless Chime Features

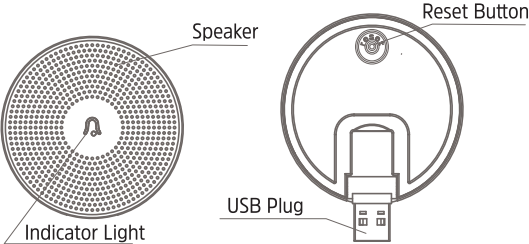

System Specifications		
Power	DC 5V, USB power supply	
Reset Button	To enter Pairing Mode ; Quickly click the reset button once. The Indicator Light will start blinking continuously. To restore factory settings; Hold down the reset button for 5 seconds. The Indicator Light will blink 3 times, then go solid.	
Indicator Light	Blinking	Pairing Mode
	Solid	Paired to Smart Video Doorbell

©2021 Energizer. Energizer and certain graphic designs are trademarks of Energizer Brands, LLC and related subsidiaries and are used under license by Jem Connected IOT, Inc. All other brand names are trademarks of their respective owners. Neither Jem Connected IOT, Inc. nor Energizer Brands, LLC is affiliated with the respective owners of their trademarks.

1

First, make sure your doorbell's Chime Setting is set to "Wireless Chime" in the app.

You can set this when accessing your doorbell for the first time, or later in your doorbell's settings.

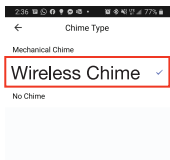
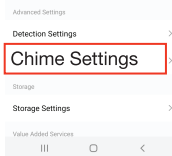
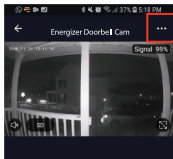

2

Plug your Wireless Chime into a wall outlet using the included USB Power Adapter.

NOTE: Wireless Chime should be plugged into a wall outlet within 30ft of doorbell.

3

To enter Pairing Mode, quickly click the Reset Button on the back of your Wireless Chime.

For Multiple Chimes:

Make sure all your Wireless Chimes are in pairing mode at the same time before moving on to Step 4. This includes previously added Wireless Chimes.

Energizer



4

Go to the Bell Settings within the Chime Settings of the doorbell. Click the BIND button.

The light on the Wireless Chime should stop blinking. Your Wireless Chime is now paired to your doorbell.



NOTE: Bell Settings will only appear after you have selected Wireless Chime as the Chime Type.

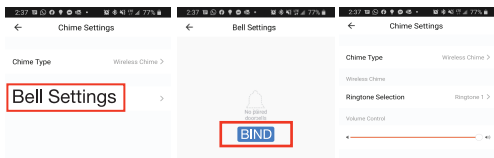

Troubleshooting:

If your Wireless Chime is not ringing when you press your doorbell

Factory reset the Wireless Chime by holding down the Reset button on the back of the Wireless Chime for 5 seconds. The indicator light will blink three times and then go solid. Now Repeat Steps 1-4.

If you don't see "Add" in Step 4

First click the Remove/Unbind button, go back to the previous menu, and re-enter Ring Settings. Double check your Wireless Chime is still blinking and then click the "BIND" button. Your Wireless Chime should now stop blinking and be paired to your doorbell.